



## CHUCKS

### FOR STAND DRILLS

**Applications:**

- For CNC machines and machining centers
- High precision and stability
- Conical insertion
- Self-tightening
- Right turn

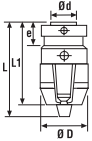

Code	Capacity Ø mm	Coupling	Measurements					Kg	Preci- sion
			d mm	l mm	D mm	L mm	L1 mm		
<b>0341</b>	1-10	B16	15,733	24,0	36	78	70	0,80	0,20
<b>0342</b>	1-13	B16	15,733	24,0	49	94,5	85,2	0,96	0,20
<b>0343</b>	1-16	B18	17,780	32,0	54	103	93	1,24	0,20
<b>0344</b>	5-20	B22	21,793	40,5	59	124,2	116	1,70	0,20
HIGH PRECISION									
<b>0331</b>	1-10	B16	15,733	24,0	36	78	70	0,80	0,05
<b>0332</b>	1-13	B16	15,733	24,0	51	106	94	0,96	0,05
<b>0333</b>	1-16	B18	17,780	32,0	54	115,2	102	1,24	0,05

### KEY TYPE DRILL CHUCK (LIGHT RANGE)

**Applications:**

- Light and battery drills
- Metal body
- Suitable for percussion

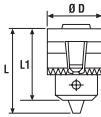

Code	Capacity Ø mm	Coupling	Measurements		
			D mm	L mm	L1 mm
<b>0311</b>	1,5 - 10	3/8-24 UNF	34	58,5	49
<b>0312</b>	1,5 - 10	1/2-20 UNF	34	58,5	49
<b>0313</b>	1,5 - 13	1/2-20 UNF	42	71,5	59

### AUTOMATIC REVERSIBLE

**Applications:**

- Professional electric and pneumatic drills
- Self-tightening
- Security click
- Suitable for percussion

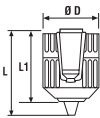

Code	Capacity Ø mm	Coupling	Measurements		
			D mm	L mm	L1 mm
<b>0321</b>	0,8 - 10	3/8-24 UNF	41	64	54,5
<b>0322</b>	0,8 - 10	1/2-20 UNF	41	64	54,5
<b>0323</b>	1,5 - 13	1/2-20 UNF	43	74,5	62

### PROFESSIONAL AUTO REVERSE

**Applications:**

- Professional electric and pneumatic drills
- Metal body
- Self-tightening
- Security click
- Suitable for percussion

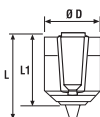

Code	Capacity Ø mm	Coupling	Measurements		
			D mm	L mm	L1 mm
<b>0351</b>	2 - 13	3/8-24 UNF	42,5	75	67
<b>0352</b>	2 - 13	1/2-20 UNF	42,5	75	67

### SDS-PLUS ADAPTERS



Code	Description
<b>0302</b>	Adapter SDS-PLUS a 1/2 - 20 UNF