



COMPRESSEURS et PNEUMATIQUE

ÉQUIPEMENT et MANUTENTION

OUTILS DE COUPE

FORETS et OUTILLAGE DE CONSTR.

DISQUES et TRÉPANS DIAMANTÉS

MACHINES et ACC. CONSTRUCTION

## Insertion HEXAGONALE 22 x 82,5

**NOUVEAUTÉ**  
**GAMME ÉLARGIE**

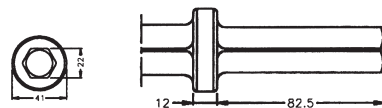

| Pointe d'attaque | Code                          | Description            | L <sub>T</sub> mm | Largeur mm |         |
|------------------|-------------------------------|------------------------|-------------------|------------|---------|
|                  | <b>00017</b><br><b>00017L</b> | Burin pointu hexagonal | 450<br>1 000      | -          | 10<br>5 |
|                  | <b>00037</b>                  | Burin plat hexagonal   | 450               | 28         | 10      |
|                  | <b>00047</b>                  | Burin brise-béton      | 450               | 75         | 5       |
|                  | <b>00057</b>                  | Pelle longue           | 460               | 80         | 5       |

Applications : GESA GA-10, GEIS BH-103, IMCOINSA 2623, TOPAC T-103, TOKU TCD-20.

## Insertion HEXAGONALE 19 x 50

**NOUVEAUTÉ**  
**GAMME ÉLARGIE**

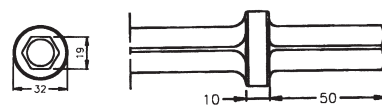

| Pointe d'attaque | Code         | Description            | L <sub>T</sub> mm | Largeur mm |    |
|------------------|--------------|------------------------|-------------------|------------|----|
|                  | <b>00016</b> | Burin pointu hexagonal | 330               | -          | 10 |
|                  | <b>00036</b> | Burin plat hexagonal   | 330               | 25         | 10 |
|                  | <b>00046</b> | Burin bêche            | 330               | 50         | 5  |

Applications : MACO MEUDON SK-5, DESA R-407, IMCOINSA 2622, TOPAC T-3.

## Insertion HEXAGONALE 25 x 108

**NOUVEAUTÉ**  
**GAMME ÉLARGIE**

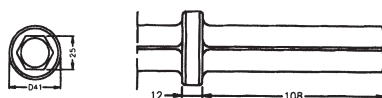

| Pointe d'attaque | Code         | Description            | L <sub>T</sub> mm | Largeur mm |    |
|------------------|--------------|------------------------|-------------------|------------|----|
|                  | <b>00018</b> | Burin pointu hexagonal | 500               | -          | 10 |
|                  | <b>00038</b> | Burin plat hexagonal   | 500               | 30         | 10 |
|                  | <b>00048</b> | Burin brise-béton      | 500               | 75         | 5  |
|                  | <b>00058</b> | Pelle longue           | 520               | 80         | 5  |

Applications : MACO MEUDON MK-15, MK-16, STANLEY BR-40, BR-45, TOKU TP-20, IMCOINSA 2643.